



# BEACON 2

Portable Sound System



## Perfect for...

- Indoor & Outdoor Events
- Schools & Universities
- Sporting Events
- Graduations
- Auditoriums
- Assemblies
- House of Worship
- Parks & Recreation
- Auctions
- Military Training & Ceremonies
- Fitness Centers
- Parades & Community Celebrations
- Ceremonies
- Rental
- Public Gatherings
- Weddings
- Cemeteries & Funerals
- Libraries
- Camps
- and more!

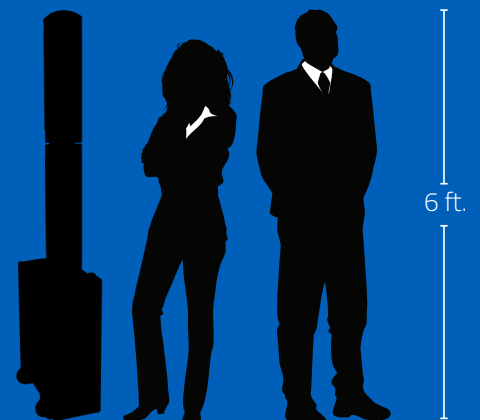

## TECH SPECS

- 120 dB of clear sound
- 200W AC/DC RMS
- 1.9 GHz wireless microphone frequency
- 300'+ wireless microphone range
- Two universal mic inputs
- 1/4" & 3.5 mm AUX line input
- 1/4" line output
- Built-in rechargeable Lithium Ion batteries
- Lightweight line array tower has eight 4" neodymium speakers
- Base has three 8" neodymium subwoofers

## FEATURES

- Reach crowds of 2,500+
- Connect up to four wireless mics
- Anchor AIR wireless companion speaker compatible
- Built-in Class 1 Bluetooth
- Nylon mic storage bag
- Durable wheels and retractable handle for easy transport
- Built-in rechargeable batteries operate 6 - 8 hours on a single charge

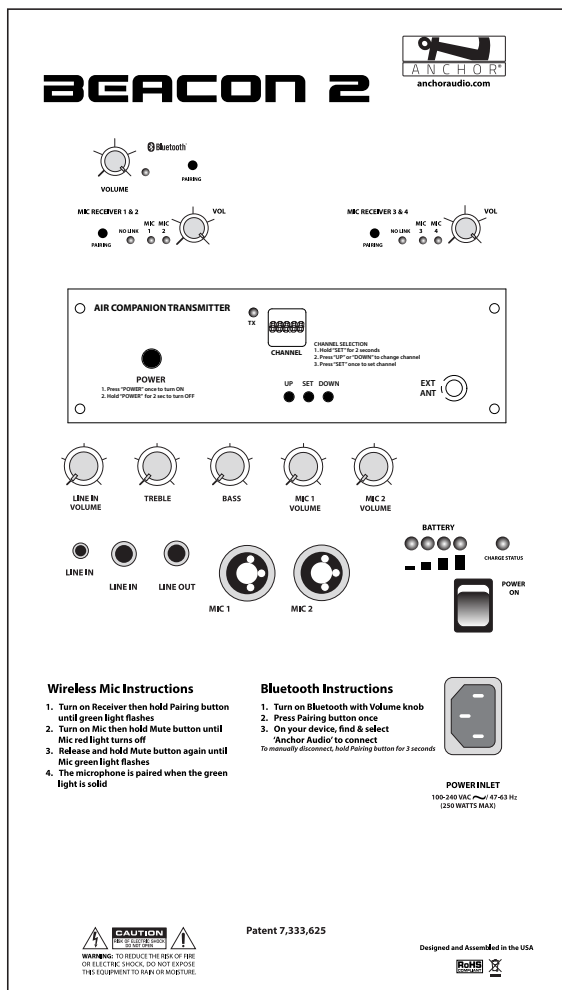

(BEA2-XU4 Back Panel)  
Beacon Control Panel Silkscreen Artwork 217-0332-000 rev. A  
(Reference dwg# 216-0332-000 for dimension & material info)

Anchor Audio, Inc.

October 10, 2017



Contact us for a quote:

www.vtix.com  
quotes@vtix.com  
903-297-4642



(Features & Specifications Subject to Change Without Notice)

Designed and Assembled in the USA

## Beacon 2 Models

BEA2	Beacon 2 with built-in Bluetooth
BEA2-U2	Beacon 2 with built-in Bluetooth & dual wireless mic receiver
BEA2-U4	Beacon 2 with built-in Bluetooth & two dual wireless mic receivers
BEA2-X	Beacon 2 with built-in Bluetooth & AIR wireless transmitter
BEA2-XU2	Beacon 2 with built-in Bluetooth, AIR wireless transmitter & dual wireless mic receiver
BEA2-XU4	Beacon 2 with built-in Bluetooth, AIR wireless transmitter & two dual wireless mic receivers
BEA2-R	Beacon 2 with built-in Bluetooth & AIR wireless receiver
BEA2-RU2	Beacon 2 with built-in Bluetooth, AIR wireless receiver & dual wireless mic receiver
BEA2-RU4	Beacon 2 with built-in Bluetooth, AIR wireless receiver & two dual wireless mic receivers

## Microphones

WH-LINK	Wireless handheld mic (1.9 GHz)
WB-LINK	Wireless belt pack transmitter (1.9 GHz)
HBM-LINK	Headband mic (3.5 mm plug)
CM-LINK	Collar mic (3.5 mm plug)
EM-LINK	UltraLite mic (3.5 mm plug)
LM-LINK	Lapel mic (3.5 mm plug)
MIC-90	Wired handheld mic with 20 ft. cable (XLR plug)

## Technical Specifications

Rated Power Output	200W AC/DC RMS
Max SPL @ Rated Power	120 dB @ 1 meter
Frequency Response	55 Hz – 17 kHz ± 3 dB
Microphone Wireless Frequency	1.9 GHz DECT
Microphone Wireless Range	300'+ line of sight
Mic Inputs	Lo-Z, balanced, XLR & 1/4" 34V DC condenser mic (phantom) power Hi-Z (10 KΩ), unbalanced, 1/4" phone
Line Inputs	Balanced Mono 1/4" & Unbalanced Stereo 3.5 mm
Line Output (post fader)	Isolated, 600Ω, 1/4" phone
AC Power Reqs.	100 – 240 VAC, 50/60 Hz, 250W max
Battery	Two 12V LFP rechargeable batteries, 7.5 AH
Dimensions Closed (HWD)	28" x 11" x 18.5" (71.1 x 28 x 47 cm)
Dimensions Opened (HWD)	71.5" x 11" x 18.5" (181.6 x 28 x 47 cm)
Weight	43 lbs / 19.5 Kg
Warranty	6 years
<b>Sensitivity For Rated Output</b>	
Lo-Z Microphone	-52 dBV (2.5 mVrms)
Hi-Z Microphone	-43 dBV (7.5 mVrms)
Auxiliary (line)	-14 dBV (200 mVrms)
<b>Anchor AIR Technical Specifications</b>	
AIR Frequency Range	902 - 928 MHz
AIR Wireless Range	300'+ line of sight